

STARRETT LEHIGH

601 WEST 26TH STREET, NEW YORK, NY

SUITE 1800 **68,604 RSF**

AVAILABLE

Jul-21

LAYOUT/CONDITION

Open Layout

Whitebox Condition

VIEWS

Panoramic Views

OTHER

Full floor opportunity

12'8" ceiling height to slab

Amazing natural light

TRANSPORTATION

A C E 7

citi bike

M23

PROPERTY FEATURES

- Landmark property located in the heart of Chelsea
- Expansive Hudson River and city views
- Modernized on-site fitness center offering training sessions
- Nationally celebrated food hall operator
- Dynamic multimedia event space
- Urban rooftop garden and beekeeping program
- RxWell platform offering best in-class comprehensive health practices

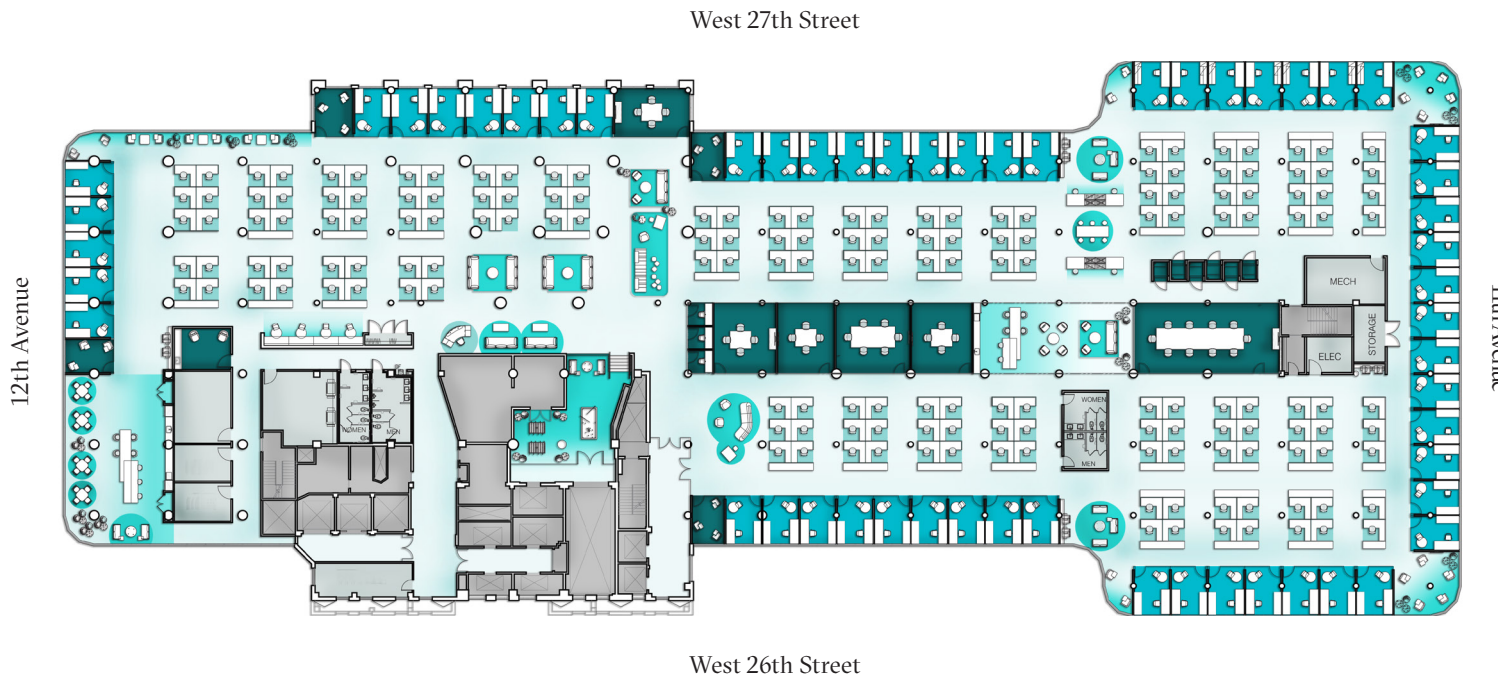

TEST FIT

- CONFERENCE ROOMS
- PRIVATE OFFICES
- PANTRIES/Common SPACES
- WORK STATIONS

SCALE: N.T.S.